

**DETAIL A**

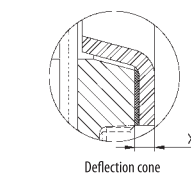

**DETAIL B**

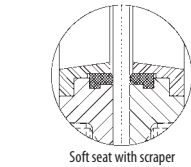
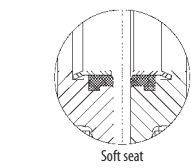
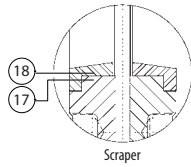
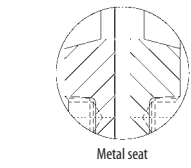
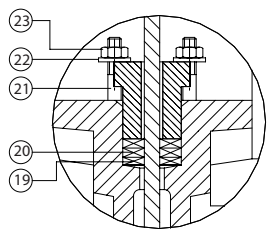

**Dimensions\***

DN	INCH	A	B	C	D	E	V	X
50	2"	40	92	220	240	425	210	9
65	2 1/2"	40	92	260	270	450	210	9
80	3"	50	92	303	295	480	210	9
100	4"	50	92	360	335	520	210	9
125	5"	50	102	428	370	600	260	9
150	6"	60	102	493	418	650	260	9
200	8"	60	119	632	522	820	300	9
250	10"	70	119	767	625	1020	300	9
300	12"	70	119	897	725	1120	300	12
350	14"	96	192	1042	845	1380	400	12
400	16"	100	192	1167	945	1490	400	12
450	18"	106	192	1297	1045	1580	500	12
500	20"	110	192	1455	1148	1690	500	12
600	24"	110	290	1705	1360	2030	500	12

**Materials\***

	GG25 type	Stainless steel type
1 <b>Body</b>	GG25	1.4408/CF8M
2 <b>Packing gland</b>	Aluminium	1.4408/SS316
3 <b>Gate</b>	1.4301/SS304	1.4408/SS316
4 <b>Support plates</b>	Steel	Steel
5 <b>Greasing</b>	Steel	Steel
6 <b>Bolts</b>	Steel	Stainless steel
7 <b>Studs</b>	Steel	Stainless steel
8 <b>Nuts</b>	Steel	Stainless steel
9 <b>Spindle</b>	1.4301/SS304	1.4301/SS304
10 <b>Grower washer</b>	Steel	Stainless steel
11 <b>Manoeuvring nut</b>	Bronze	Bronze
12 <b>Manoeuvring support</b>	Steel	Steel
13 <b>Washer</b>	Steel	Steel
14 <b>Handwheel</b>	1.4305/SS305	1.4305/SS305
15 <b>Tube</b>	Steel	Steel
16 <b>Cover</b>	Plastic	Plastic
17 <b>Seat</b>	EPDM / NBR / Viton / Silicon / Flucast ABP / PTFE	
18 <b>Ring</b>	1.4408/SS316	1.4408/SS316
19 <b>Packing</b>	Synt. + PTFE / PTFE / Graphite / Ceramic fibre	
20 <b>Toric joint</b>	Nitrile	Nitrile
21 <b>Studs</b>	Steel	Stainless steel
22 <b>Washer</b>	Steel	Stainless steel
23 <b>Nut</b>	Steel	Stainless steel

**Pressure**

DN50 - DN250:	10 bar
DN300 - DN400:	6 bar
DN450:	5 bar
DN500 - DN600:	4 bar
DN700 - DN1200:	2 bar

**Colour\***

RAL 5015

Flanges drilled according to EN 1092-2, DIN 2501: ISO PN10 and ANSI B16.5 (class 150)  
(for further informations please visit our download section on our website)

\*Other dimensions / materials / colours on request