

KH135

SELF-ADJUSTING
GLAND
REGELBARE
STOPFBUCHSE

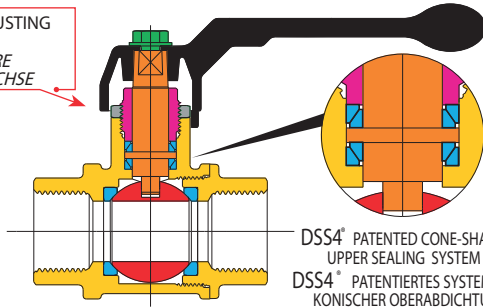

DSS4[®] PATENTED CONE-SHAPED
UPPER SEALING SYSTEM
DSS4[®] PATENTIERTES SYSTEM MIT
KONISCHER OBERABDICHTUNG

- D**
- Voller Durchgang
 - Anschluß: F/F gemäß UNI EN 10226
 - Gehäuse: Messing
 - Kugel: Messing, blank verchromt
 - Dichtung Kugel: PTFE
 - Max. Druck: 100 bar
 - Temperatur: -20°C ... + 130°C

- E**
- Full bore
 - Connection: F/F acc. to UNI EN 10226
 - Body: Brass
 - Ball: Brass, chromium polished
 - Ball seats: PTFE
 - Max. pressure: 100 bar
 - Temperature: -20°C ... + 130°C



Atex II 2 GD

* Marking Atex on request
* Atex Markierung auf Anfrage



KH135-MMTLI

Materials

Nr.	Bauteil / Part	Material	Oberflächenbehandlung / Surface treatment
1	Gehäuse / Body	Messing / Brass (CW617N/2.0402)	Glänzend vernickelt / brilliant nickel-plated
2	Kugel / Ball	Messing / Brass (CW617N/2.0402)	blank verchromt / chromium polished
3	Kugeldichtung / Ball seats	PTFE	
4	Gewindemuffe / Threaded ends	Messing / Brass (CW617N/2.0402)	
5	Stopfbuchse / Gland	Messing / Brass (CW614N/2.0401)	
6	Gegenmutter / Gland nut	Messing / Brass (CW614N/2.0401)	
7	Spindel / Stem	Messing / Brass (CW617N/2.0402)	
8	Handhebel / Handlever	Alu-Legierung / Aluminium Alloy	
9	Befestigungsschraube / Fixing screw	Zinkstahl / Zinc plated steel	

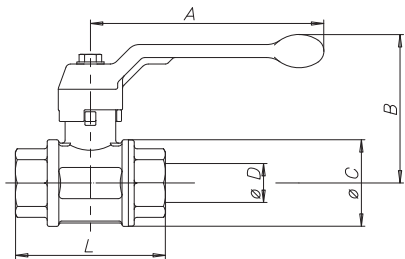

Maße / Dimensions [mm]

DN	INCH	øD	A	B	øC	L	Kv
6	1/8"	8	75	52	23	48	5
8	1/4"	8	75	52	23	51	6
10	3/8"	10	100	61	29	55	8
15	1/2"	15	100	64	36	69	15
20	3/4"	20	120	76	45	77	28
25	1"	25	120	80	54	89	39
32	1 1/4"	32	150	98	65	103	84
40	1 1/2"	40	150	104	79	114	156
50	2"	50	175	119	96	134	243
65	2 1/2"	65	280	155	119	160	476
80	3"	80	280	167	144	185	770

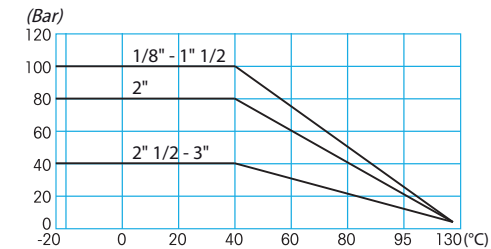

KH135-MMTLI

copyright © by
FERGO[®] Armaturen GmbH

Blindeisenweg 31
D-41468 Neuss

Tel.: +49(0) 2131 - 15 39 28-0
Fax: +49(0) 2131 - 15 39 28-99

Web: www.fergo.biz
E-Mail: info@fergo.biz

fergo[®]