

Straight-through type diaphragm valve with threaded ends

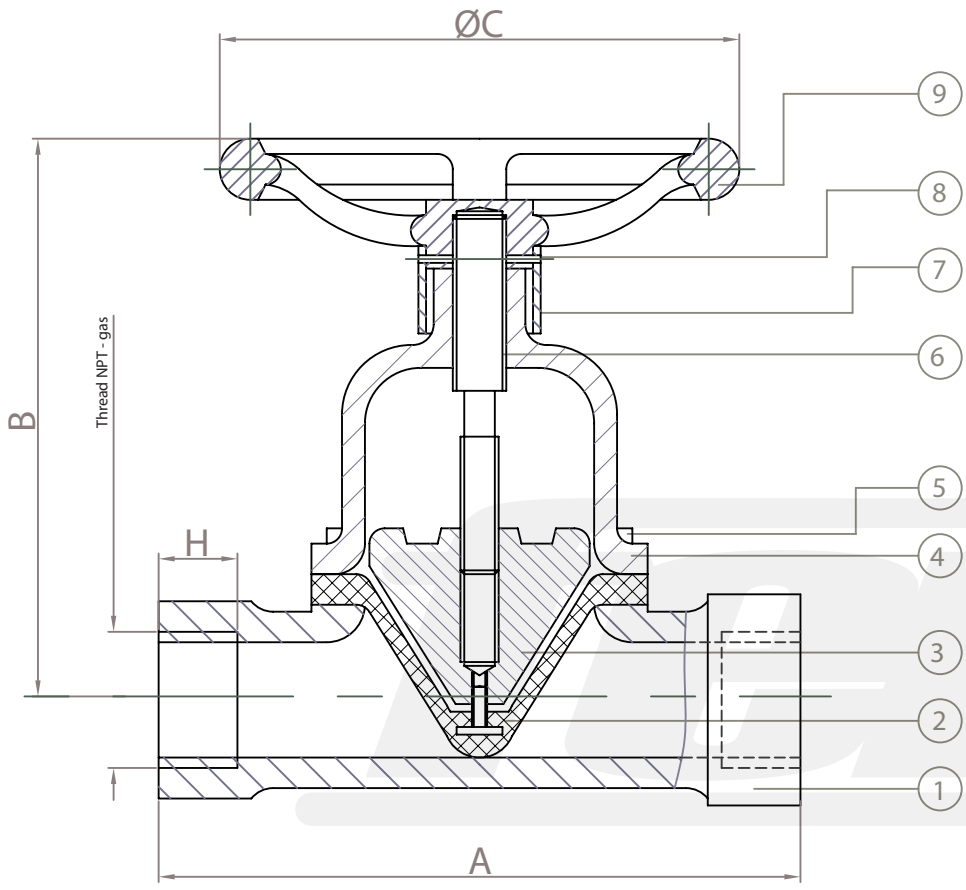

Dimensions\*

DN	INCH	Ø C	B	A	H	Weight, [kg]
20	3/4"	120	152	113	12	1,5
25	1"	120	152	113	12	2
32	1 1/4"	120	155	135	15	3
40	1 1/2"	120	155	140	15	4
50	2"	160	165	165	15	8

Materials\*

1	<b>Body</b>	Ductile iron
2	<b>Diaphragm</b>	Rubber
3	<b>Compressor</b>	Cast iron
4	<b>Bonnet</b>	Cast iron
5	<b>Union studs</b>	8.8
6	<b>Spindle</b>	Stainless steel
7	<b>Collar indicator</b>	PVC
8	<b>Pin</b>	Steel
9	<b>Handwheel</b>	Cast iron

Pressure:

DN20 - DN50: 7 bar  
DN65: 5 bar

Colour\*

 RAL 5015

For further informations please visit our download section on our website.

\*Other dimensions / materials / colours on request