

Size: 1/2" - 2 1/2"

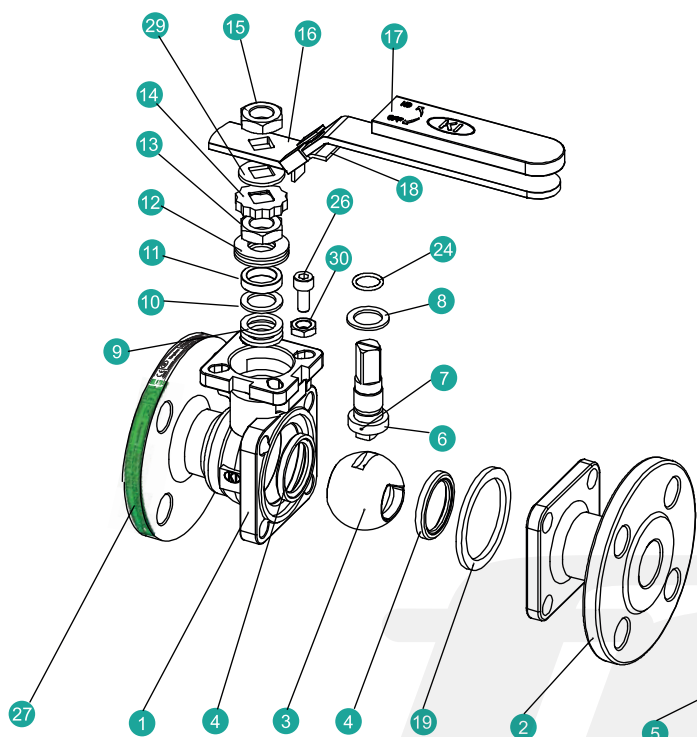

Size: 3" - 8"

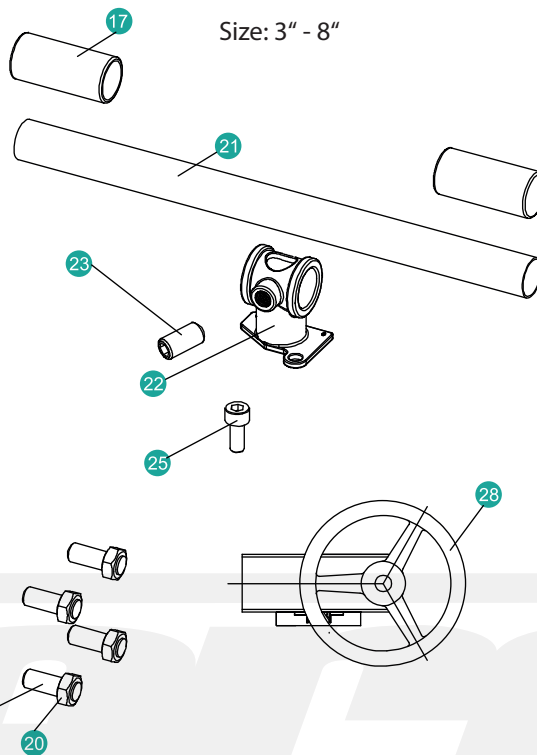

Merkmale / Features

- Bauform: 2-teiliger Kugelhahn
- Direkter Antriebsaufbau nach ISO 5211
- Fire-Safe: API 607, ISO 10497
- Ausblässichere Welle
- TA-Luft / ISO 15848-1
- Druck-Ausgleichsöffnung im Ballschlitz
- Temp. (min./max.): -30°C bis +200 °C
- Druckklassen: ASME 150lbs & 300lbs
- Design: ASME B16.34
- Baulänge: ASME B16.10
- Flanschanschluss: ASME B16.5
- SIL 3 nach IEC 61508:2010
- ATEX: II 2G Ex h IIB T3 Gb / II 2D Ex h IIIC T180°C Db

- Design: 2-piece ball valve
- Direct mounting standard: ISO 5211
- Fire Safe: API 607, ISO 10497
- Blow-out proof stem
- TA-Luft / ISO 15848-1
- Pressure balance hole in ball slot
- Temp. (min./max.): -30°C to +200 °C
- Pressure rating: ASME 150lbs & 300lbs
- Design: ASME B16.34
- Face to face: ASME B16.10
- Flanged ends: ASME B16.5
- SIL 3 IEC 61508:2010
- ATEX: II 2G Ex h IIB T3 Gb / II 2D Ex h IIIC T180°C Db

Werkstoffe / Materials

Nr.	Bezeichnung / Description	Material	Material
1	Endstück / End Cap	A351 CF8M (1.4408)	A216 WCB (1.0619)
2	Gehäuse / Body	A351 CF8M (1.4408)	A216 WCB (1.0619)
3	Kugel / Ball	AISI 316	AISI 304
4	Kugeldichtung / Ball seat	TFM1600 / PTFE / TFM4215	
5	Stehbolzen / Bolting	A193-B8	A193-B7
6	Schaltwelle / Stem (1/2"-5")	AISI 316	AISI 304
6	Schaltwelle / Stem (6")	S32205	S32205
7	Anti-Statik-Gerät / Anti Static Device	AISI 316	AISI 304
8	Sicherungsring / Thrust washer	PTFE / TFM1600	
9	Wellenabdichtung / Stem Packing	PTFE / Grafit*	
10	Buchsabdichtung / Bushing	50%SS + 50%PTFE / AISI 304 *	
11	Stopfbuchse / Gland	AISI 316	
12	Tellerfeder / Belleville Washer	AISI 301	
13	Spindelmutter / Stem nut	A194-8	
14	Schraubensicherung / Stop-lock-cap	AISI 304	
15	Hebelsicherung / Handle Nut (1/2" - 2 1/2")	A 194-8	
16	Handhebel / Lever (1/2" - 2 1/2")	AISI 304	
17	Hebelüberzug / Handle Sleeve	PVC	
18	Verschluss / Lock Device (1/2" - 2 1/2")	AISI 304	
19	Gehäusedichtung / Body Gasket	PTFE / AISI 316 Spiral Wound + Grafit *	
20	Mutter / Bolt Nut	A194-8	A194-2H
21	Handgriff / Pipe Handle (3" - 8")	A53 + Zn Plated	
22	Hebel Adapter / Handle Adapter (3" - 8")	A351-CF8	
23	Madenschraube / Set screwed	A2-70	
24	O-Ring / O-Ring	FKM (Viton)	
25	Bolzen / Bolting (3" - 8")	A2-70	
26	Anschlag / Stop Bolt	A2-70	
27	Typenschild / Nameplate	AISI 304	
28	Schneckengetriebe / Worm Gear		
29	Stützscheibe / Support Washer	AISI 304	
30	Sicherungsmutter / Stop nut	A2-70	

* Fire Safe



KH155

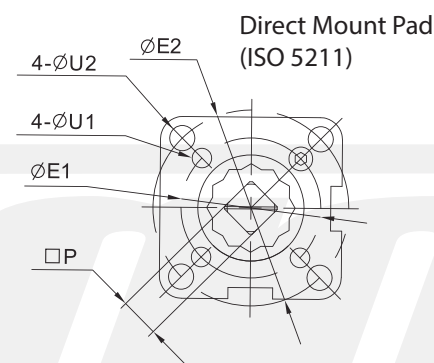
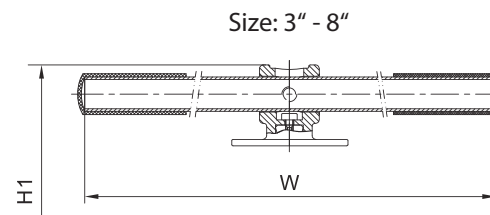
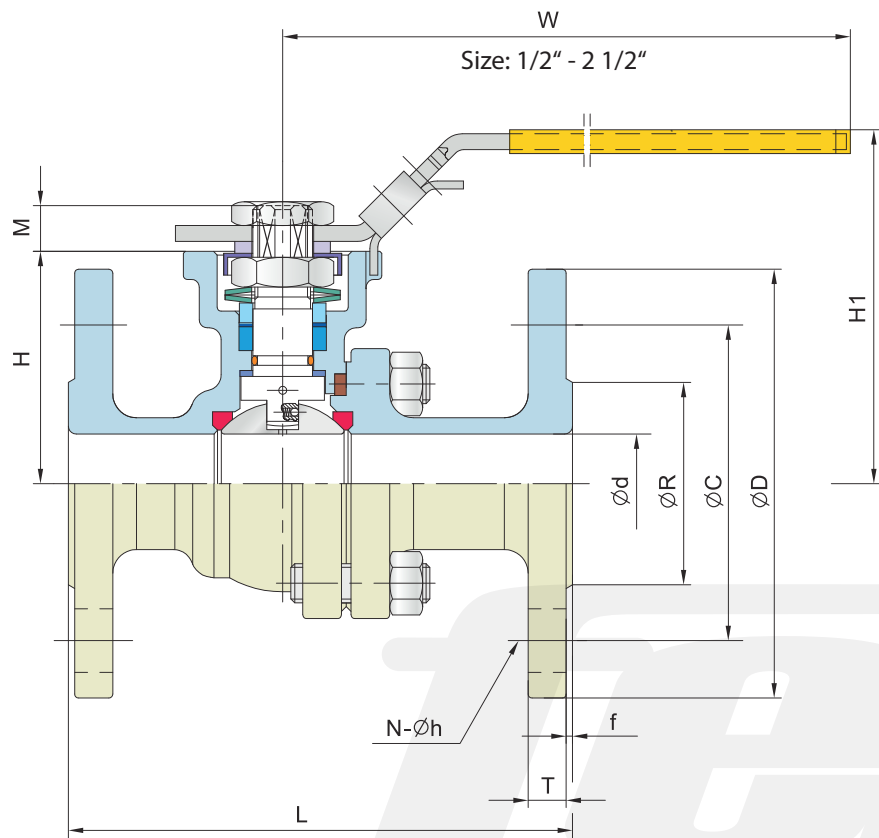

ASME CLASS 150 - Abmessungen / Dimensions [mm]

Size	d	L	R	D	C	T	f	N	h	H	H1	W	M	P	E1	E2	U1	U2	ISO 5211	Kv [m³/h]	Weight [KG]
1/2"	15	108	35	90	60,3	8	2	4	16	49	79	147	9	9	36	42	6	6	F03 - F04	25,95	1,6
3/4"	20	117	43	100	69,9	8,9	2	4	16	53	84	147	9	9	36	50	6	7	F03 - F05	47,58	2,3
1"	25	127	51	110	79,4	9,6	2	4	16	59	90	177	11	11	42	50	6	7	F04 - F05	83,04	3,0
1 1/4"	32	140	63,5	115	88,9	11,2	2	4	16	71	102	177	11	11	42	70	6	9	F04 - F07	147,05	3,5
1 1/2"	38	165	73,2	125	98,4	12,7	2	4	16	76	110	197	14	14	50	70	7	9	F05 - F07	233,55	5,6
2"	50	178	92	150	120,7	14,3	2	4	19	82	115	197	14	14	50	70	7	9	F05 - F07	406,55	8,4
2 1/2"	63,5	190	104,7	180	139,7	15,9	2	4	19	102	150	267	17	17	70	102	9	11	F07 - F10	674,7	14,5
3"	76	203	127	190	152,4	17,5	2	4	19	112	176	300	17	17	70	102	9	11	F07 - F10	994,75	18,5
4"	100	229	157	230	190,5	22,3	2	8	19	140	211	400	22	22	-	102	-	11	F10	1816,5	29,5
5"	125	356	186	255	215,9	22,3	2	8	22,3	183	263	600	27	27	125	-	14	-	F12	3027,5	53,5
6"	150	394	216	280	241,3	23,9	2	8	22,3	204	284	800	27	27	125	-	14	-	F12	4325	74,0
8"	200	457	270	345	298,5	27	2	8	22,3	253	352	800	36	36	-	140	-	18	F14	8217,5	132,0

ASME CLASS 300 - Abmessungen / Dimensions [mm]

Size	d	L	R	D	C	T	f	N	h	H	H1	W	M	P	E1	E2	U1	U2	ISO 5211	Kv [m³/h]	Weight [KG]
1/2"	15	140	35	95	66,7	12,7	2	4	16	49	79	147	9	9	36	42	6	6	F03 - F04	25,95	2,54
3/4"	20	152	43	115	82,6	14,3	2	4	19	59	89	147	9	9	36	42	6	6	F03 - F04	47,58	3,64
1"	25	165	51	125	88,9	15,9	2	4	19	64	95	177	11	11	42	50	6	7	F04 - F05	83,04	4,55
1 1/4"	32	178	63,5	135	98,4	17,5	2	4	19	71	102	177	11	11	42	50	6	7	F04 - F05	147,05	5,17
1 1/2"	38	190	73,2	155	114,3	19,1	2	4	22,3	80	113	197	14	14	50	70	7	9	F05 - F07	233,55	8,69
2"	50	216	92	165	127	20,7	2	8	19	85	118	197	14	14	50	70	7	9	F05 - F07	406,55	10,9
2 1/2"	63,5	241	104,7	190	149,2	23,9	2	8	22,3	102	150	267	17	17	70	102	9	11	F07 - F10	674,7	17,5
3"	76	282	127	210	168,3	27	2	8	22,3	112	176	300	17	17	70	102	9	11	F07 - F10	994,75	27,3
4"	100	305	157	255	200	30,2	2	8	22,3	140	211	400	22	22	-	102	-	11	F10	1816,5	41,8
5"	125	381	186	280	235	33,4	2	8	22,3	183	263	600	27	27	125	-	14	-	F12	3027,5	67,6
6"	150	403	216	320	269,9	35	2	12	22,3	204	284	800	27	27	125	-	14	-	F12	4325	100,6
8"	200	502	270	380	330,2	39,7	2	12	25,4	253	352	800	36	36	-	140	-	18	F14	8217,5	170

Druck-Temperatur-Diagramm / Pressure temperature diagram

Floating ball valves ASME

Size: 1/2" - 1"

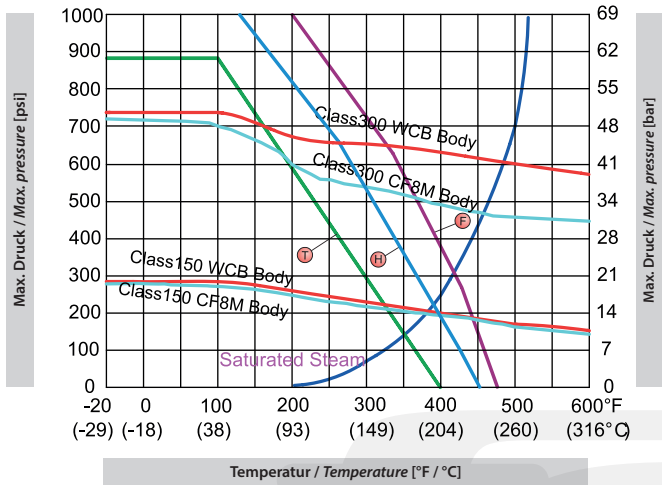

Size: 1 1/4" - 2 1/2"

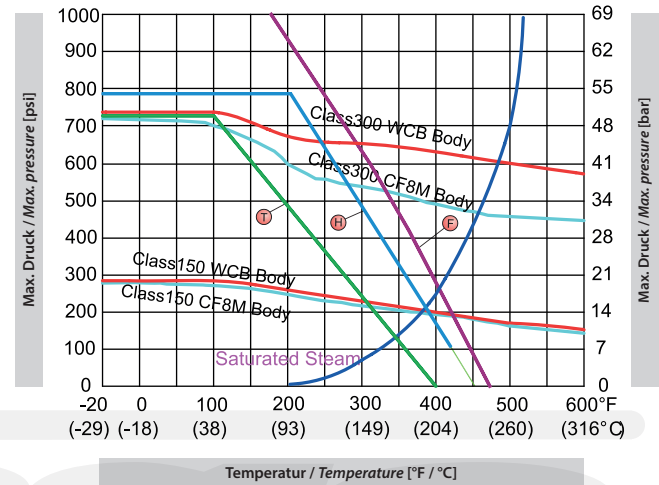

Size: 3" - 4"

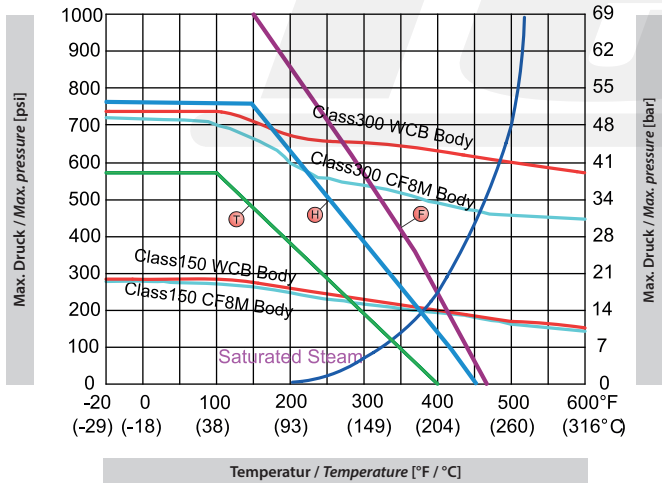

Size: 5" - 8"

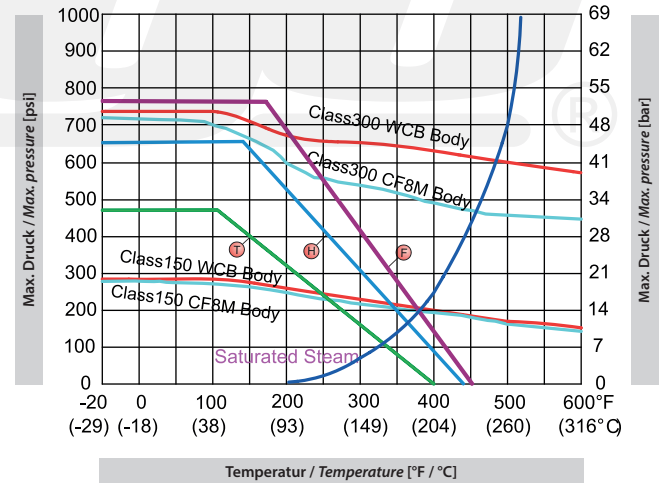

Legende:

- T PTFE
- H TFM1600
- F TFM4215